

**"BUTTON-LRGB/LED3": 3W RGB LED LIGHT SOURCE COLOR CONTROL BUTTON**

The Led light sources LRGB-LED Series are produced to be used with glass and pmma optical fibres.

These light sources allow you to control the emitted light and color rotation speed, creating spectacular effects through radio frequency control.

The light sources are supplied with an electronic device for connection to an unlimited number of led light sources which maintaining the color sync.

**TECHNICAL FEATURES**

3W RGB LED high power  
Fanless cooling  
IP54 protection (IP65 on request)  
Led lifespan 50.000 hours  
Supply voltage: 230V-50/60Hz

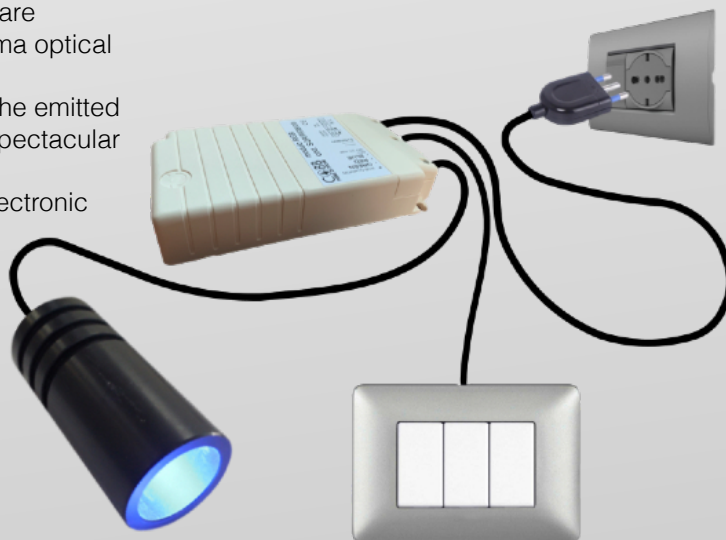

**RGB COLOR CONTROL BUTTON**



**COLOR CONTROL BUTTON FUNCTIONS**

One push-button to control all functions

**SHORT PUSH :**

- switch on or switch off

**LONG PUSH :**

- color selection / automatic color rotation starts after 20 seconds

**TWO SHORT PUSHES :**

- fixed color choice in automatic color rotation program

**"BUTTON-LRGB/LED3" SYSTEM'S COMPONENTS**

**3W RGB LED LIGHT SOURCE**



**COLOR CONTROL MODULE**



**BUTTON FOR COLOR CONTROL**  
(button not included in the supply)

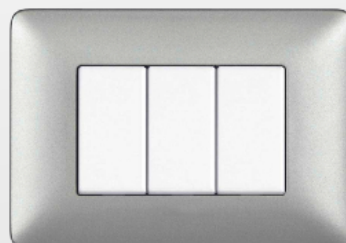

**DIMENSIONS**

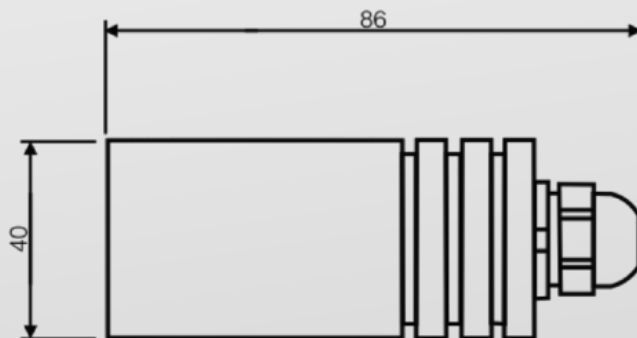

**LED LIGHT SOURCE - FIBRE OPTIC BUNDLE CONNECTION**



**3W RGB LED LIGHT SOURCE**

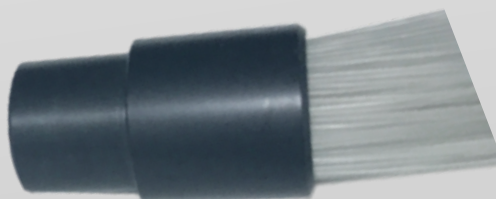

**COMMON END**

**FIBRE OPTIC BUNDLE**



**INSERT THE COMMON END IN THE LIGHT SOURCE AND BLOCK IT  
THROUGH THE SCREW SET ON THE LIGHT SOURCE**